

Planning Permit No. CP/114/13  
**APPROVED**  
 SUBJECT TO THE CONDITIONS IN THIS OFFICE STAMP.  
 No. 2227/79 dt. 7.12.79  
 FOR THE SECRETARY  
 MADRAS METROPOLITAN DEVELOPMENT AUTHORITY  
 MADRAS - 600 008.

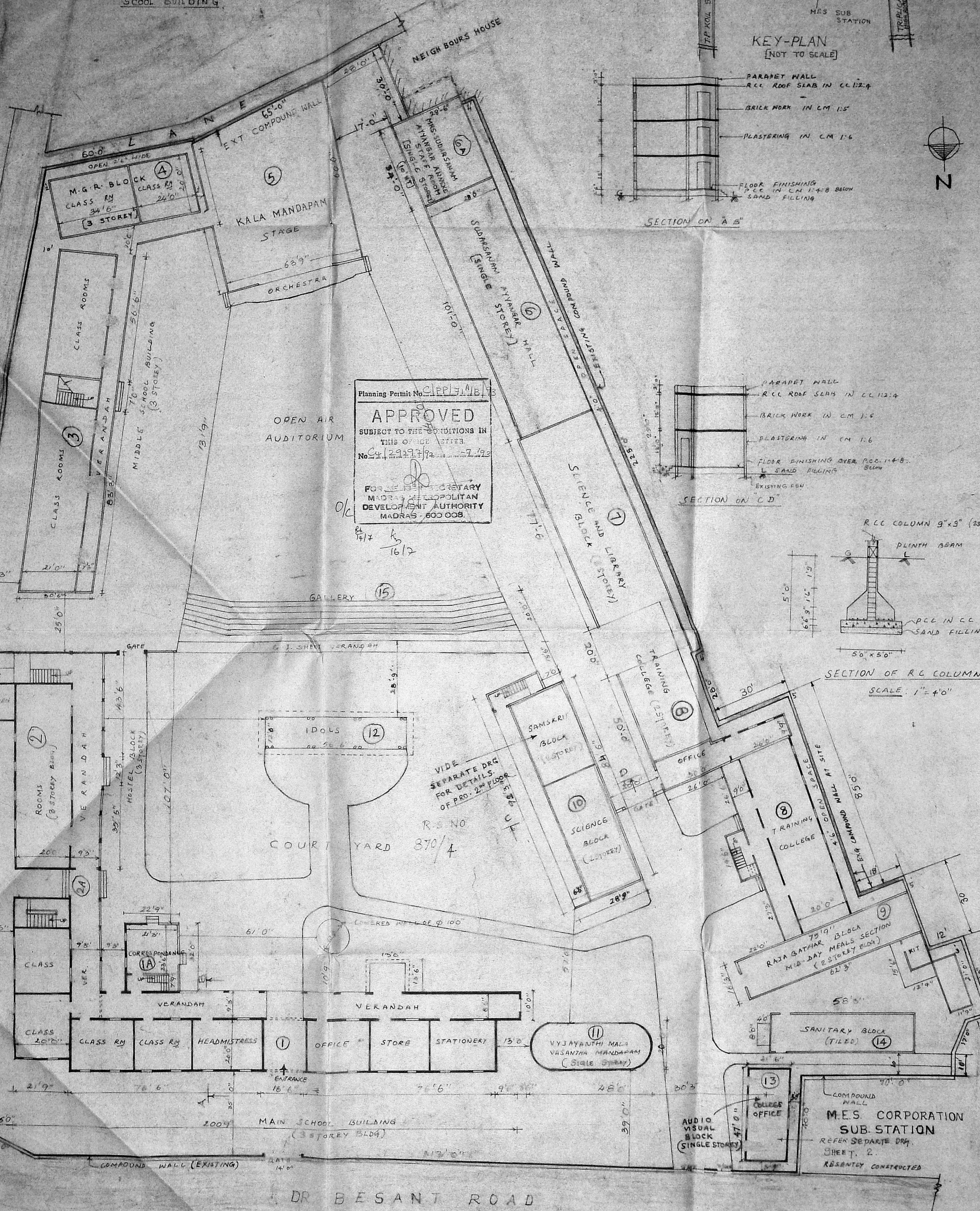

TOTAL FLOOR AREAS OF BUILDINGS

S.N.	DESCRIPTION	AREA IN SQ. FT.	AREA IN SQ. M.
1	MAIN SCHOOL BUILDING (GROUND + 2 FLOORS)	21426	1993
1A	CORRESPONDENT ROOM (GROUND + 1 FLOOR)	1456	135
2	HOSTEL BUILDING (GROUND + 2 FLOOR)	8623	802
	TOILET BLOCK	378	35
	KITCHEN BLOCK	168	16
2A	CONNECTING CORRIDOR (GROUND FLOOR)	121	11
3	MIDDLE SCHOOL BUILDING (GROUND + 2 FLOOR)	13428	1249
4	M.G.R. BLOCK (CLASS ROOMS) (GROUND + 2 FLOOR)	5170	481
5	KALA MANDAPAM - STAGE (G.I. SHEET ROOF)	4144	385
6	MS. SUDARSANAM AYYANGAR ANNEXE (GROUND + 1 FLOOR) STAFF ROOM (10' x 10')	1046	97
6A	MS. SUDARSANAM AYYANGAR MANSION (GROUND FLOOR)	4059	382
7	SCIENCE AND LIBRARY BLOCK (GROUND + 1 FLOOR)	4882	454
8	TRAINING COLLEGE (GROUND + 1 FLOOR)	9590	892
9	RAJA BATHAR BLOCK (GROUND + 1 FLOOR)	2382	268
10	SANSKRIT & SCIENCE BLOCK (GROUND + 1 FLOOR) (G.I. SHEET ROOF)	5413	503
	FRONT VERANDAH	2707	252
11	VYJAYANTHI MALA VASANTHA MANDAPAM (GROUND FLOOR)	960	89

GROUND FLOOR PLAN CUM SITE PLAN

S.N.	DESCRIPTION	AREA IN SQ. FT.	AREA IN SQ. M.
12	IDOLS BLOCK (GROUND FLOOR)	678	63
13	COLLEGE OFFICE (GROUND FLOOR)	785	73
14	SANITARY BLOCK (GROUND FLOOR)	964	90
15	GALLERY (OPEN)	3000	279

SITE AREA : 2 CAN. 734/1685 SPT

PLINTH AREA OF ALL THE BUILDINGS (INCLUDING ALL FLOORS AND VERANDAS) : 51890 SQ. FT. OR 4848 SQ. M.

COLOUR INDEX

- EXISTING BUILDING
- ROADS
- BOUNDARY OF SITE
- PROPOSED (2ND FLOOR)

PLAN SHOWING THE EXISTING SCHOOL BUILDINGS OF N. K. THIRUMALACHARIAR NATIONAL GIRLS' HIGHER SECONDARY SCHOOL & TRAINING COLLEGE FOR WOMEN, 21, DR. BESANT RD, TRIPPLICANE, MADRAS 600015

SCALE: 1" = 20' 0"

DATE: 25-10-91 TO BE REGULARISED.

R/S. NO: 870/4, 870/2  
 BLOCK NO. 16  
 PREVIOUS SANCTIONED PLAN P/R NO 2680/90 dt. 16/4/90  
 B.A. NO 2948/90 dt. 30/5/90

DRG. SHEET NO: 1 SA/194/91  
 READ WITH SHEET 2 & 3

For N. K. THIRUMALACHARIAR NATIONAL GIRLS' HIGHER SECONDARY SCHOOL  
 S. ANANTHACHARI, F.I.R.A., M.I.S.E.,  
 Registered Architect & Engineer No. GA. 7504,  
 Class - 1, 21, Dr. Besant Rd.,  
 CORPORATION OF MADRAS,  
 38, VENKATACHALAM STREET,  
 TRIPPLICANE, MADRAS-600 008  
 LICENSED SURVEYOR



